

ITEM NO.	QTY.	PART NUMBER	DESCRIPTION	WEIGHT
1	1	F2-RBP1000-LR-HG	F2 BASE SECTION (SHS) - Round Base Plate	74.1 lb (33.7 kg)
2	1	T50 TOP POLE (HG)	DN50 [NPS 2.0in] TOP POLE	37.4 lb (17.0 kg)
3	1	CP10-150-001-HG	CLAMP PLATE 10mm	2.0 lb (0.9 kg)
4	4	FSNK-002-HG	1/2" Fastener Kit (50Hex-Bolt, Ft-Wshr, Sp-Wshr)	0.18 lb (0.08 kg)
5	1	SP10-HG	SAFETY PIN AND CABLE	0.15 lb (0.07 kg)

POLE TOP OPTIONS

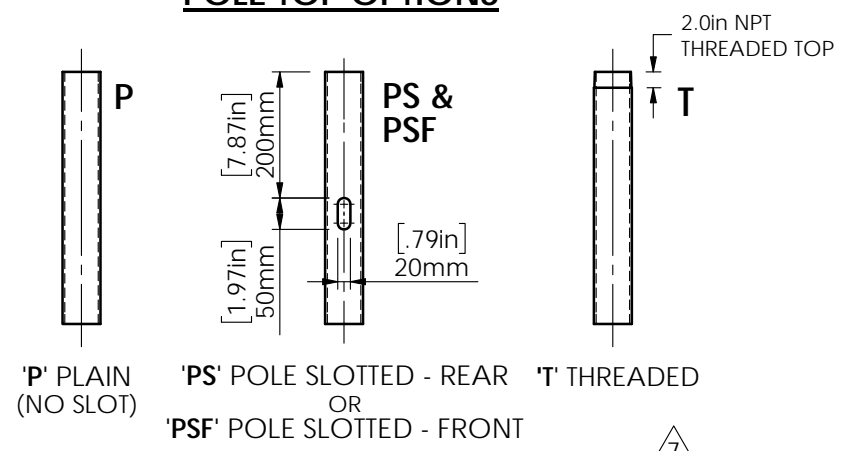

INSTALLED HEIGHT	PRODUCT CODE	NEC / IEC
4000 [13']	F2-4000-P-HG	NEC
4000 [13']	F2-4000-PS-HG	IEC
4000 [13']	F2-4000-PSF-HG	IEC
4000 [13']	F2-4000-T-HG	NEC

POLE PART No.	WEIGHT
F2-4000 Series	114.4 lb (52.0 kg)

(with ROUND BASE PLATE)

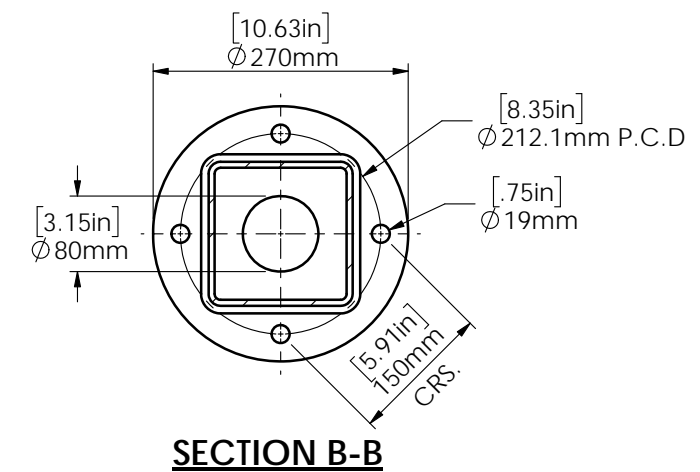

F2 - FLOOR MOUNTED POLE
TYPICAL INSTALLATION

NEC / IEC

Scan Code with QR Reader app for more Swivelpole™ F2 Information

PATENTED PRODUCTS

www.swivelpole.com

This document is the property of and protected by copyright owned by Swivelpole Group Pty Ltd. The designs and other information embodied in this document comprise confidential information of Swivelpole Group Pty Ltd and form part of products covered by international patents and registered designs including US patent No 6957832. Unauthorised use, reproduction and disclosure are strictly prohibited. This document must not be removed from the premises of the licensed user of this document without Swivelpole Group Pty Ltd's prior approval.

ALL DIMENSIONS ARE IN MILLIMETERS/INCHES	PROJECT SWIVELPOLE	SERIES / CODE F	PART NUMBER As Shown	(RQ1283)
DRAWN BY AD	DATE 20-09-09	TITLE Swivelpole™ F2 - Round Base Plate		
CHECKED BY FB	DATE 20-03-10	General Assembly		
APPROVED BY PP	DATE 31-03-10	Client Detail		
THIRD ANGLE PROJECTION	SCALE 1:7.5	DRG No C-NA-F2-001-HG	REV 7	A3