

INSTALLED VIEW

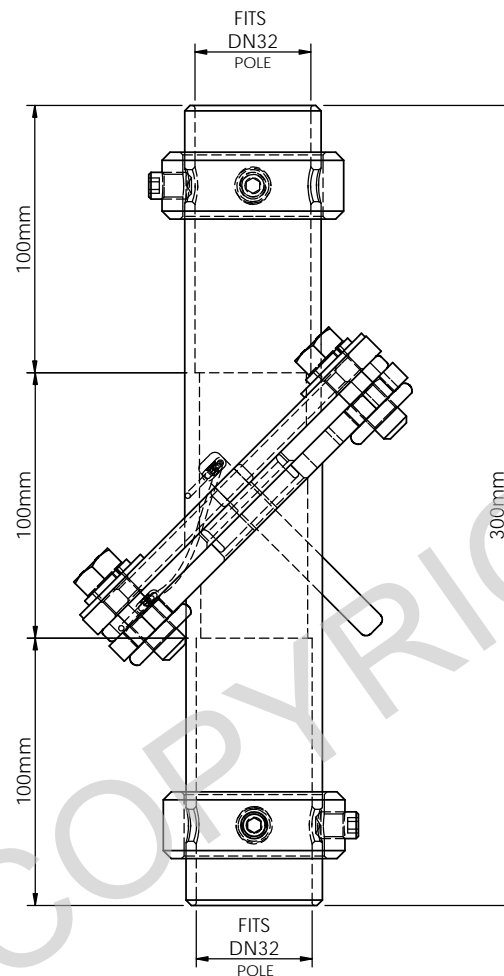

HIDDEN DETAIL VIEW

PART NUMBER = R11-32-HG

MATERIAL = Steel (AS3678 & AS1163)
FINISH = Hot Dipped Galvanized (AS4680)
WEIGHT = 5.0kg

ITEM No.	QTY.	PART NUMBER	DESCRIPTION (DETAIL)
1	1	R-T32-HG	DN32 [Ø 42.2mm] TOP SECTION
2	1	R-B32-LR-HG	DN32 [Ø 42.2mm] BASE SECTION
3	1	CP08-150-001-HG	8mm CLAMP PLATE
4	2	RC32-HG	DN32 [Ø 42.2mm] LOCKING COLLAR
5	1	SP10-HG	SAFETY PIN AND CABLE
6	4	FSNK-001-DM	M12 FASTENER KIT
7	4	M10x16GS-HG	GRUB SCREWS M10

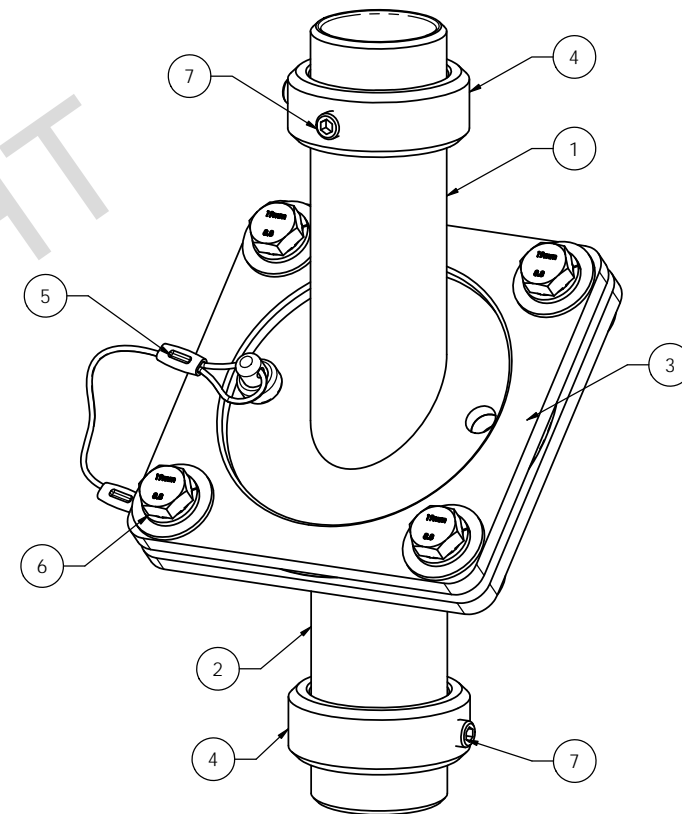

ASSEMBLED ISOMETRIC VIEW



Scan Code with
QR Reader app for more
Safe Swivel Joint
Product Information

**PATENTED
PRODUCTS**

www.swivelpole.com

Swivelpole

This document is the property of and protected by copyright owned by Swivelpole Group Pty Ltd. The designs and other information embodied in this document comprise confidential information of Swivelpole Group Pty Ltd and form part of products covered by international patents and registered designs including US patent No 6957832. Unauthorised use, reproduction and disclosure are strictly prohibited. This document must not be removed from the premises of the licensed user of this document without Swivelpole Group Pty Ltd's prior approval.			
ALL DIMENSIONS ARE IN MILLIMETERS	PROJECT SWIVELPOLE	SERIES / CODE R	PART NUMBER R11-32-HG (RQ1259)
DRAWN BY AD	DATE 06-10-09	Swivelpole™ R11 DN32 [Ø 42.2mm] Safe Swivel Joint General Assembly	
CHECKED BY FB	DATE 15-06-10		
APPROVED BY PP	DATE 16-06-10		
THIRD ANGLE PROJECTION	SCALE 1:2	DRG No C-AU-R11-32-HG	REV 1 A3

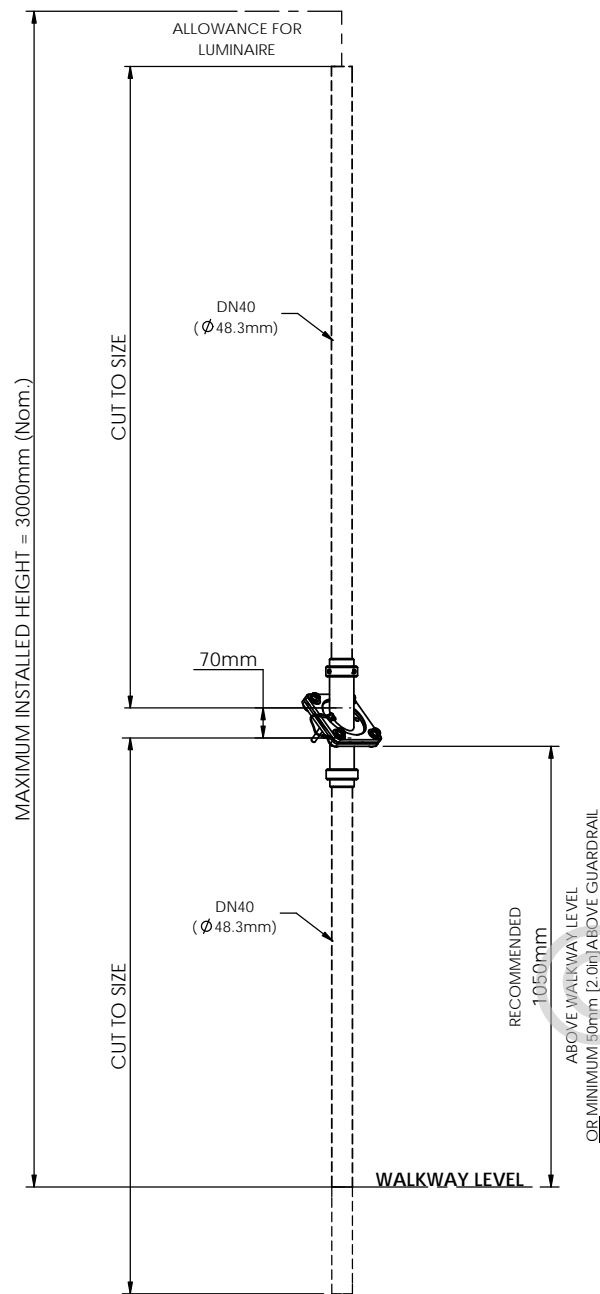

INSTALLED VIEW

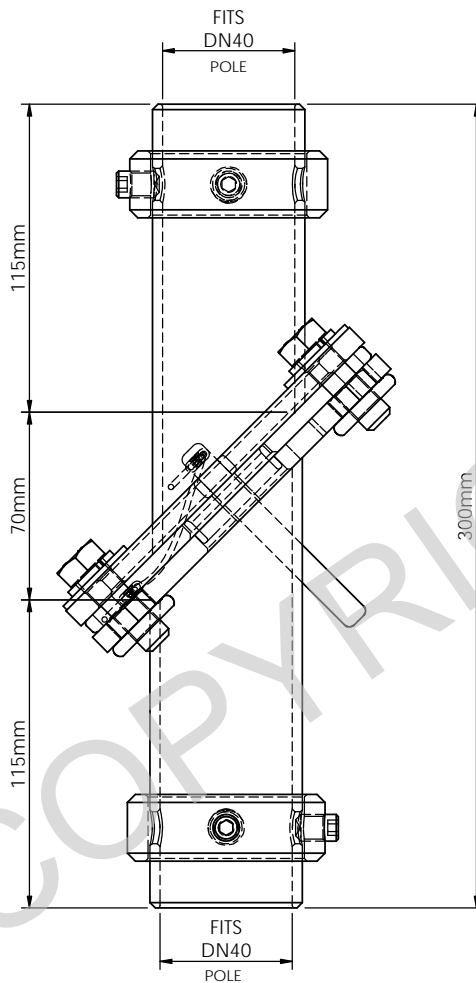

HIDDEN DETAIL VIEW

PART NUMBER = R11-40-HG

MATERIAL = Steel (AS3678 & AS1163)
FINISH = Hot Dipped Galvanized (AS4680)
WEIGHT = 5.1kg

ITEM No.	QTY.	PART NUMBER	DESCRIPTION (DETAIL)
1	1	R-T40-HG	DN40 [Ø48.3mm] TOP SECTION
2	1	R-B40-LR-HG	DN40 [Ø48.3mm] BASE SECTION
3	1	CP08-150-001-HG	8mm CLAMP PLATE
4	2	RC40-HG	DN40 [Ø48.3mm] LOCKING COLLAR
5	1	SP10-HG	SAFETY PIN AND CABLE
6	4	FSNK-001-DM	M12 FASTENER KIT
7	4	M10x16GS-HG	GRUB SCREWS M10

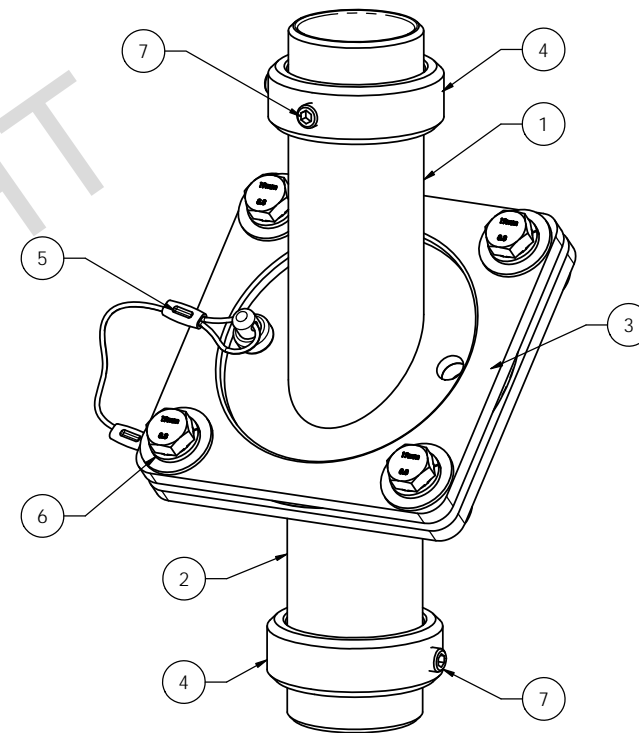

**ASSEMBLED
ISOMETRIC VIEW**



Scan Code with
QR Reader app for more
Safe Swivel Joint
Product Information

**PATENTED
PRODUCTS**

www.swivelpole.com

Swivelpole

This document is the property of and protected by copyright owned by Swivelpole Group Pty Ltd. The designs and other information embodied in this document comprise confidential information of Swivelpole Group Pty Ltd and form part of products covered by international patents and registered designs including US patent No 6957832. Unauthorised use, reproduction and disclosure are strictly prohibited. This document must not be removed from the premises of the licensed user of this document without Swivelpole Group Pty Ltd's prior approval.

ALL DIMENSIONS ARE IN MILLIMETERS	PROJECT	SERIES / CODE	PART NUMBER	TITLE
	SWIVELPOLE	R	R11-40-HG	(RQ1259)
DRAWN BY	AD	DATE	06-10-09	
CHECKED BY	FB	DATE	25-03-10	
APPROVED BY	PP	DATE	30-03-10	
THIRD ANGLE PROJECTION	SCALE	1:2	DRG No	C-AU-R11-40-HG
			REV	1
				A3

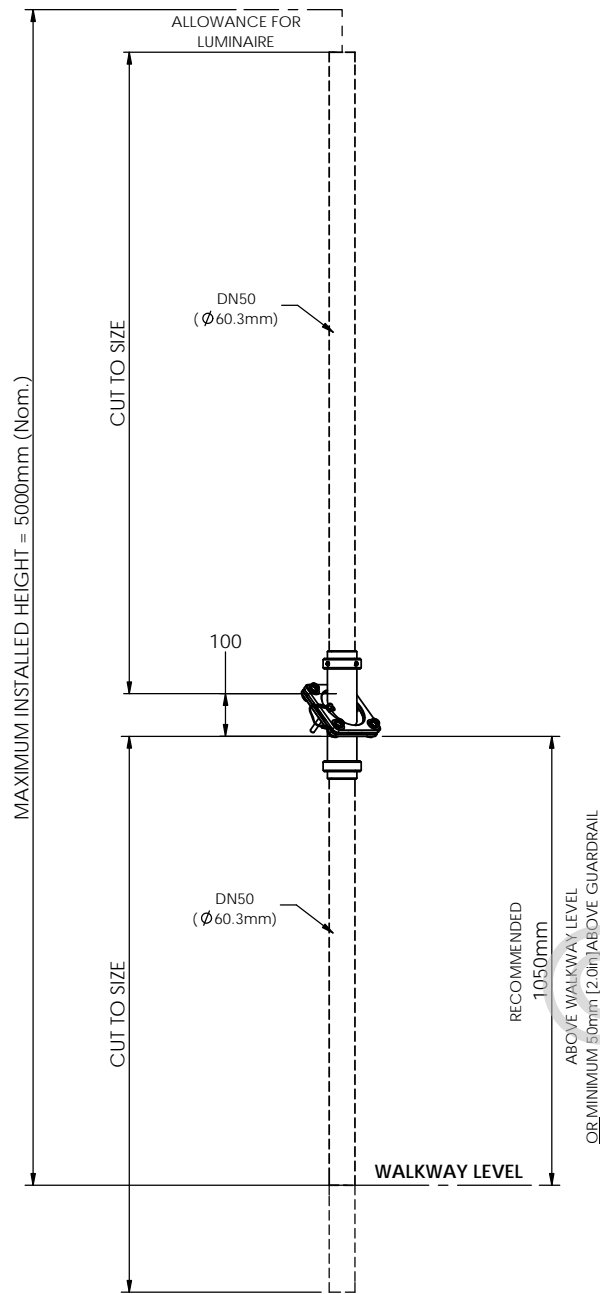

INSTALLED VIEW

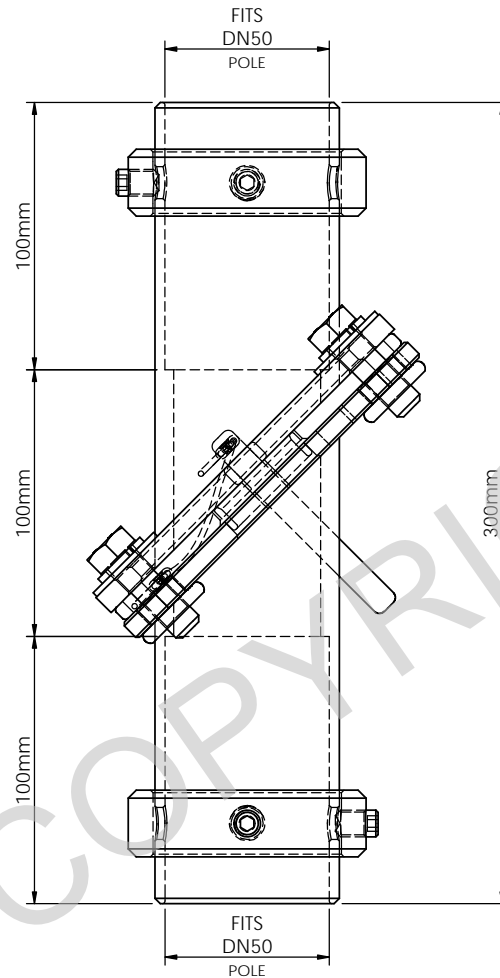

HIDDEN DETAIL VIEW

PART NUMBER = R11-50-HG

MATERIAL = Steel (AS3678 & AS1163)
FINISH = Hot Dipped Galvanized (AS4680)
WEIGHT = 6.0kg

ITEM No.	QTY.	PART NUMBER	DESCRIPTION (DETAIL)
1	1	R-T50-HG	DN50 [Ø60.3mm] TOP SECTION
2	1	R-B50-LR-HG	DN50 [Ø60.3mm] BASE SECTION
3	1	CP08-150-001-HG	8mm CLAMP PLATE
4	2	RC50-HG	DN50 [Ø60.3mm] LOCKING COLLAR
5	1	SP10-HG	SAFETY PIN AND CABLE
6	4	FSNK-001-DM	M12 FASTENER KIT
7	4	M10x16GS-HG	GRUB SCREWS M10

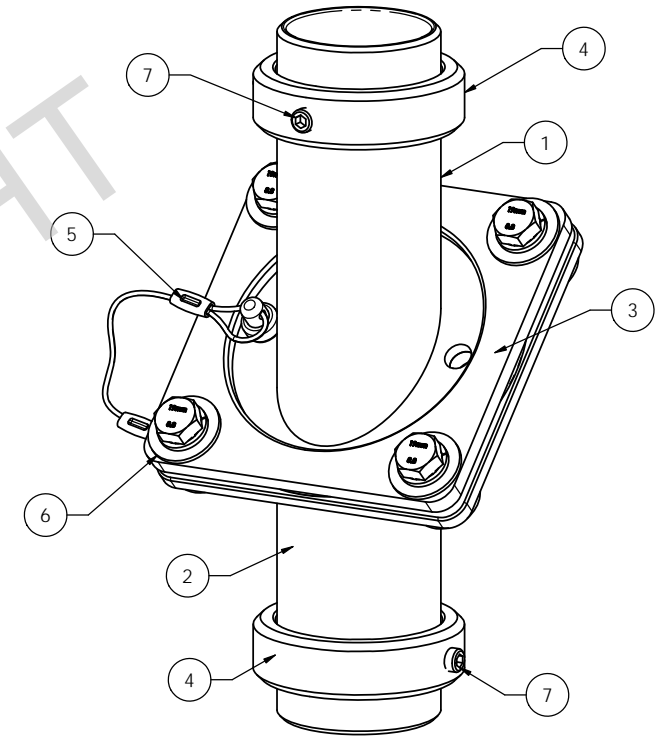

**ASSEMBLED
ISOMETRIC VIEW**



Scan Code with
QR Reader app for more
Safe Swivel Joint
Product Information

**PATENTED
PRODUCTS**

www.swivelpole.com

Swivelpole

This document is the property of and protected by copyright owned by Swivelpole Group Pty Ltd. The designs and other information embodied in this document comprise confidential information of Swivelpole Group Pty Ltd and form part of products covered by international patents and registered designs including US patent No 6957832. Unauthorised use, reproduction and disclosure are strictly prohibited. This document must not be removed from the premises of the licensed user of this document without Swivelpole Group Pty Ltd's prior approval.			
ALL DIMENSIONS ARE IN MILLIMETERS	PROJECT SWIVELPOLE	SERIES / CODE R	PART NUMBER R11-50-HG (RQ1259)
DRAWN BY AD	DATE 06-10-09	TITLE Swivelpole™ R11 DN50 [Ø60.3mm] Safe Swivel Joint General Assembly	
CHECKED BY FB	DATE 25-03-10		
APPROVED BY PP	DATE 30-03-10		
THIRD ANGLE PROJECTION	SCALE 1:2	DRG No C-AU-R11-50-HG	REV 1 A3